



4Runner

2005

Pocket Reference Guide



Introducing the new

2005 4Runner

GET THE FEELING. TOYOTA.

This *Pocket Reference Guide* is a summary guide for basic vehicle operations. It contains brief descriptions of fundamental operations so you can locate and use the vehicle's main equipment quickly and easily.

The *Pocket Reference Guide* is not intended as a substitute for the *Owner's Manual* located in the vehicle's glove box. We strongly encourage you to review the *Owner's Manual* and supplementary manuals so you will have a better understanding of the vehicle's capabilities and limitations.

Your dealership and the entire staff of Toyota Motor Sales, U.S.A., Inc., wish you many years of satisfied driving in your new 4Runner.

! A word about safe vehicle operations

This *Pocket Reference Guide* is not a full guide to 4Runner operations. Every 4Runner owner should review the *Owner's Manual* that accompanies this vehicle.

Pay special attention to the boxed information highlighted in yellow throughout the *Owner's Manual*. Each box contains safe operating instructions to help you avoid injury or equipment malfunction.

⚠ CAUTION

Utility vehicles have a significantly higher rollover rate than other types of vehicles. See page 24 in this guide for important rollover information.

All information in this *Pocket Reference Guide* is current at the time of printing. Toyota reserves the right to make changes at any time without notice.

TABLE OF CONTENTS

Item	Page no.
OVERVIEW	
Engine compartment	7
Fuel tank door opener and cap	6
Hood release lever	6
Indicator symbols	4-5
Instrument cluster	4
Instrument panel	2-3
FEATURES/OPERATIONS	
Air conditioning/Heating	15
Audio	16-17
Auto lock function-Programmable¹	8
Auto LSD (Auto Limited Slip Differential)	18
Automatic transmission	8
Bottle holders	18
Clock	12
Cruise control	14
Cup holders	18
Engine immobilizer	15
Four-wheel drive	9
Garage door opener (HomeLink [®]) ²	14
Keyless entry	19
Light-Instrument panel	10
Lights & turn signals	12
Power outlets	19
Seat adjustments-Front	10
Seat adjustments-Rear	11
Seats-Head restraints	10
Tilt and telescopic steering wheel	13
Window-Back	13
Windows	13
Window wiper & washer	11
SAFETY AND EMERGENCY FEATURES	
Airbag-Supplemental Restraint System	22-23
ATrac (Active Traction Control)	21
DAC (Downhill Assist Control)	21
Door locks-Power	20
Doors-Child safety locks	20
Parking brake	22
Rollover information	24
Seat belts	20
Seat belts-Shoulder belt anchor	21
Spare tire & tools	25
Tire Pressure Warning System	22
TRAC (Traction Control)	21
VSC (Vehicle Stability Control)	21

¹ Programmable by consumer. For dealer-programmable features, please visit your Toyota dealer.

² HomeLink[®] is a registered trademark of Johnson Controls, Inc.

OVERVIEW

Instrument panel

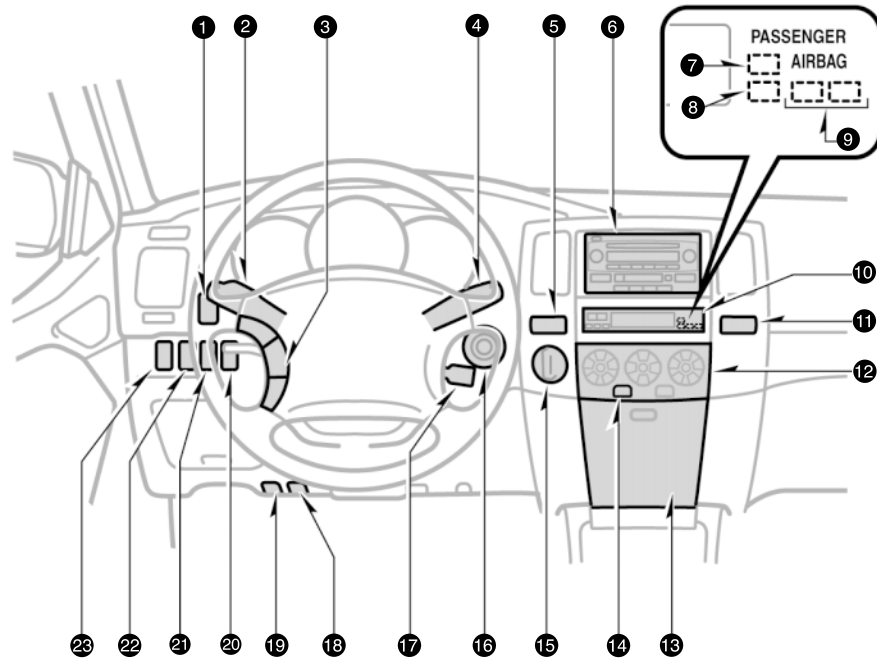

- ❶ Instrument panel light control
 - ❷ Headlight, turn signal and front fog light¹ control
 - ❸ Audio steering wheel switches¹
 - ❹ Wiper and washer controls
 - ❺ Power back window switch
 - ❻ Audio or Navigation system^{1,2}
 - ❼ Front passenger's seat belt reminder light
 - ❽ Theft deterrent system/Engine immobilizer indicator light
 - ❾ Front passenger occupant classification indicator lights
 - ❿ Multi-information display
 - ⓫ Emergency flasher switch
 - ⓬ Air conditioning controls
 - ⓭ Auxiliary box
 - ⓮ Back window and outside rearview mirror defogger
 - ⓯ Four-wheel drive selector¹ (full-time 4WD models) or two wheel/four-wheel drive selector¹ (part-time 4WD models)
 - ⓰ Ignition switch
 - ⓱ Cruise control lever
 - ⓲ Hood lock release lever
 - ⓳ Fuel tank door opener
 - ⓴ "RSCA OFF" (Roll Sensing of Curtain shield Airbags OFF) switch¹
 - ⓵ "AUTO LSD" switch¹
 - ⓶ Center Differential switch¹
 - ⓷ 115V Power Outlet main switch¹
- ¹If installed
²For details, refer to the *Navigation System Owner's Manual*.

Instrument cluster

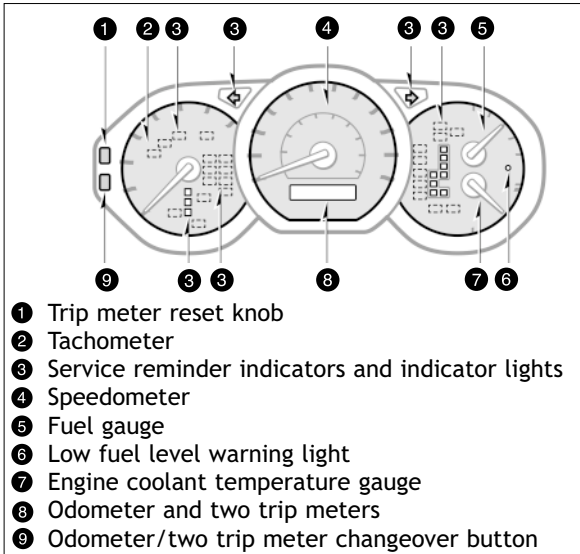

Indicator symbols

	Brake system warning light ¹
	Driver's/Front passenger's seat belt reminder light ¹
	Battery warning light ¹
	Low engine oil pressure warning light ¹
	Malfunction indicator light ¹
MAINT	Engine oil replacement reminder light ¹
ABS	Anti-lock Brake System warning light ¹

CAUTION

When the Anti-lock Brake System (ABS) function is in action, you may feel the brake pedal pulsating and hear a noise. In this situation, to let the Anti-lock Brake System work for you, just hold the brake pedal down more firmly. Do not pump the brake as this will result in reduced braking performance.

- Vehicle Stability Control warning light¹
- "AUTO LSD" warning light¹
- Traction Control warning light¹
- Downhill Assist Control warning light¹
- Active Traction Control warning light¹
- Hill-start Assist Control warning light¹

VSC TRAC	
	Open door warning light ¹
	Airbag SRS warning light ¹
A/T OIL TEMP	Automatic transmission fluid temperature warning light ¹
	Low Tire Pressure Warning light ¹
	Theft deterrent/Engine immobilizer system indicator light
RSCA OFF	Roll Sensing of Curtain shield Airbag off indicator light ^{1,2}
PASSENGER AIRBAG OFF ON	Front passenger occupant classification indicator light
	Headlight low/high beam indicator light
	Turn signal indicator light
PRND 4 3 2 L	Automatic transmission indicator lights
4LO	Low speed four-wheel drive indicator light ³
	Center differential lock indicator light ³
	Four-wheel drive indicator light ³
VSC OFF	Vehicle Stability Control off indicator light
	Slip indicator light
AUTO LSD	"AUTO LSD" indicator light
	Downhill Assist Control indicator light
HI N LO	Height control indicator lights
OFF	Height control "OFF" indicator light ⁴
CRUISE	Cruise control indicator light ⁵

¹ For details, refer to "Service reminder indicators and warning buzzers," Section 1-6, 2005 Owner's Manual.

² For details, see "Roll sensing of curtain shield airbags off switch," Section 1-3, 2005 Owner's Manual.

³ If this light flashes, refer to "Four-wheel drive system," Section

1-7, 2005 Owner's Manual.

⁴ If this light flashes, refer to "Rear height control air suspension," Section 1-7, 2005 Owner's Manual.

⁵ If this light flashes, refer to "Cruise control," Section 1-7, 2005 Owner's Manual.

Fuel tank door opener and cap

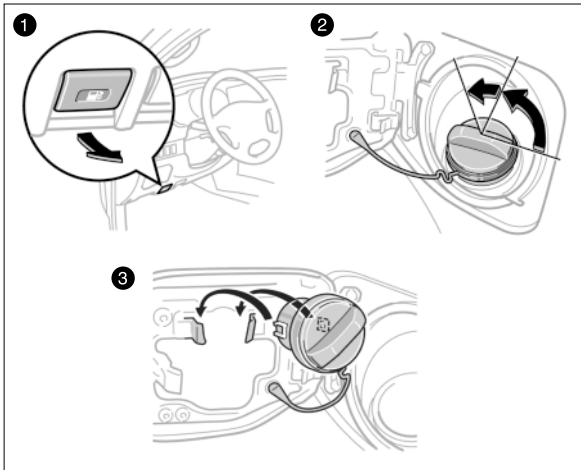

- ❶ To open the fuel tank door Pull the lever inside the vehicle.
- ❷ To remove the fuel tank cap Turn the cap counterclockwise 90 degrees, then turn it an additional 30 degrees. Pause slightly before removing it.
- ❸ The removed cap can be stored on the fuel tank door.
- ❹ To replace the fuel tank cap Turn clockwise until a click is heard. If not tightened enough, Check Engine "CHECK" indicator may illuminate.

Hood release lever

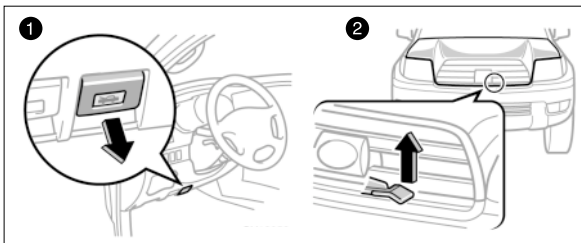

- ❶ To release the hood Pull the lever inside vehicle.
- ❷ To open the hood Insert finger through the opening between the bumper and grill. Pull up on the catch lever inside the compartment and lift the hood.

Engine compartment

6 cylinder (1GR-FE) engine

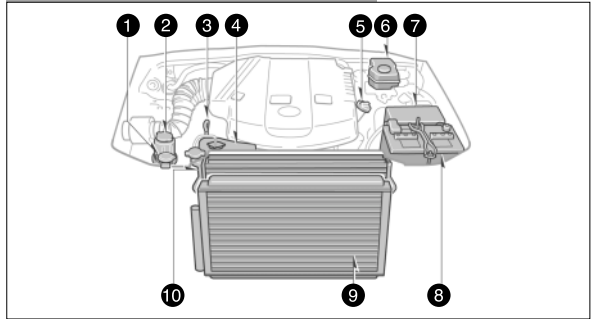

8 cylinder (2UZ-FE) engine

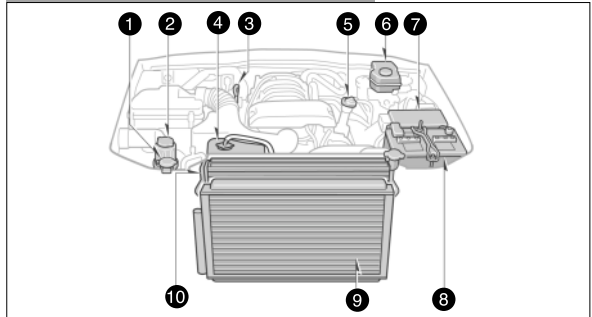

- ❶ Windshield and back window washer fluid tank
- ❷ Power steering fluid reservoir
- ❸ Engine oil level dipstick
- ❹ Engine coolant reservoir
- ❺ Engine oil filler cap
- ❻ Brake fluid reservoir
- ❼ Fuse block
- ❽ Battery
- ❾ A/C Condenser
- ❿ Radiator

Note: Regularly scheduled maintenance, including oil changes, will help extend the life of your vehicle and maintain performance. Please refer to the "Owner's Warranty Information Booklet," "Scheduled Maintenance Guide" or "Owner's Manual Supplement."

FEATURES/OPERATIONS

Auto lock functions-Programmable

Door locks can be programmed to operate in four (4) different modes:

Auto shift-locking All doors lock when the gear selector is moved out of "P" Park position with the ignition switch in the "ON" position.

Auto shift-unlocking All doors unlock when the gear selector is moved into "P" Park position with ignition in the "ON" position.

Auto speed-locking All doors lock when vehicle speed reaches 12 mph or higher.

Auto door-unlocking All doors unlock when driver door is opened within 10 seconds after ignition switch is turned from "ON" to "ACC" or "LOCK."

Refer to the *Owner's Manual* for more information on this feature, and how to change modes.

Automatic transmission

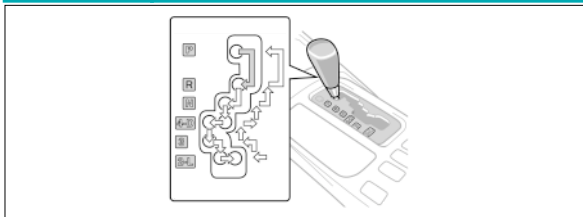

↓ When shifting from "P" (Park), the ignition switch must be "ON," and the brake pedal depressed.

↕ Shift normally.

- P** Park Engine starting and key removal
- R** Reverse
- N** Neutral
- D** Drive Overdrive ON*
- 4** Fourth gear Overdrive OFF
- 3** Third gear Increased engine braking
- 2** Second gear Increased engine braking
- L** First gear Maximum engine braking

*Downshifting increases power going uphill, or provides engine braking going downhill. For best fuel economy during normal driving conditions, always drive with the shift lever in the "D" position.

Four-wheel drive (if installed)

Part-time four-wheel drive models

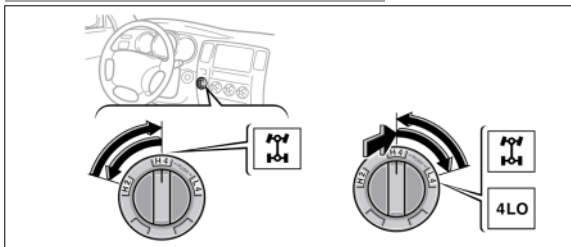

To operate the two-wheel/four-wheel drive selector

- H2** ↔ **H4** Turn
- H4** → **L4** Push and Turn
- H4** ← **L4** Turn

- H2** High speed position, two-wheel drive
- H4** High speed position, four-wheel drive
- L4** Low speed position, four-wheel drive

For best fuel economy during normal driving conditions, drive in the "H2" position.

Full-time four-wheel drive models

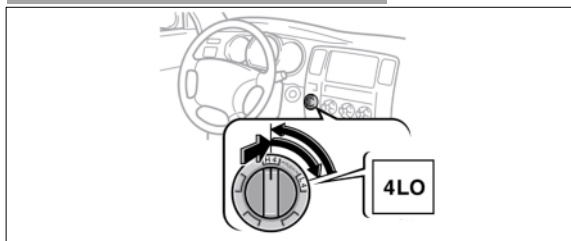

To operate the four-wheel drive selector

- H4** → **L4** Push and Turn
- H4** ← **L4** Turn

- H4** High speed position, four-wheel drive
- L4** Low speed position, four-wheel drive

For best fuel economy during normal driving conditions, drive in the "H4" position.

Refer to the *Owner's Manual* for more details.

Light-Instrument panel

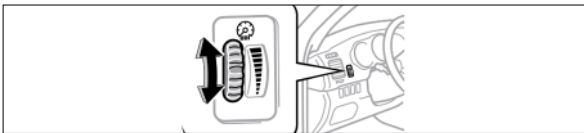

To adjust the brightness of the instrument panel
Rotate the wheel up to increase, or down to decrease the brightness of the instrument panel lights.

Seat adjustments-Front

Manual Seat

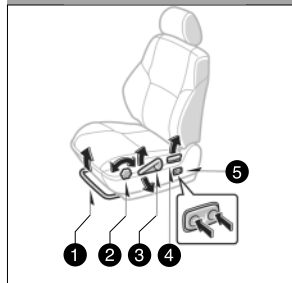

Power Seat

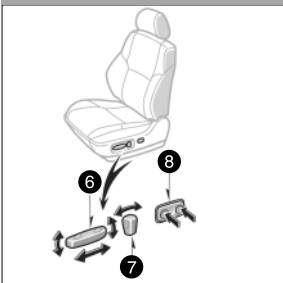

- 1 Position lever
- 2 Cushion angle knob
- 3 Cushion height crank Driver side only. Crank up to raise, or down to lower.
- 4 Seatback angle lever
- 5 Lumbar support switch
- 6 Driver's seat: position and cushion angle/height switch
Passenger's seat: position switch
- 7 Seatback angle switch
- 8 Lumbar support switch

Seats-Head restraints

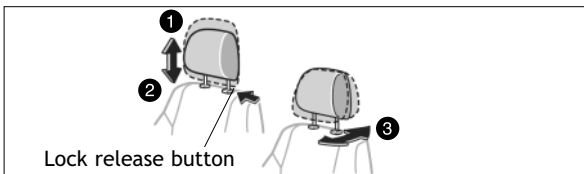

- 1 To raise Pull up the head restraint.
- 2 To lower Push down the head restraint while pressing the lock release button.
- 3 To adjust angle Move the base forward or backward.

Seat adjustments-Rear

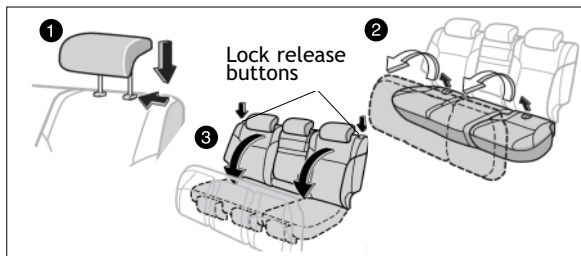

To fold rear seats

- 1 Lower the head restraints.
- 2 Pull the bottom of the seats forward using the tabs.
- 3 Push the lock release button and fold the seatback down.

Refer to the *Owner's Manual* for more details.

Window wiper & washer

Windshield

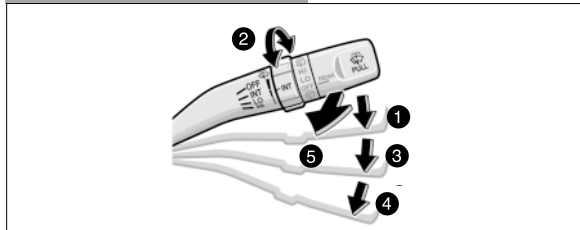

- 1 Intermittent speed Push the lever down to position 1.
- 2 Interval adjuster Twist the band to adjust the intermittent speed.
- 3 Slow speed Push the lever down to position 3.
- 4 Fast speed Push the lever down to position 4.
- 5 Wash and wipe Pull the lever toward you.

Back window

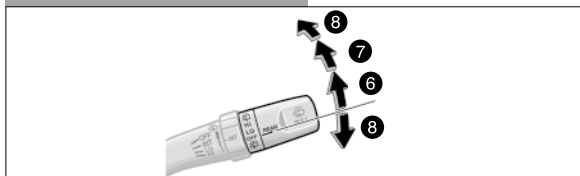

- 6 Intermittent Twist the lever knob to position 6.
- 7 Normal speed Twist the lever knob to position 7.
- 8 Rear wash and wipe Twist the lever knob upward or downward to position 8.

Lights & turn signals

Headlights

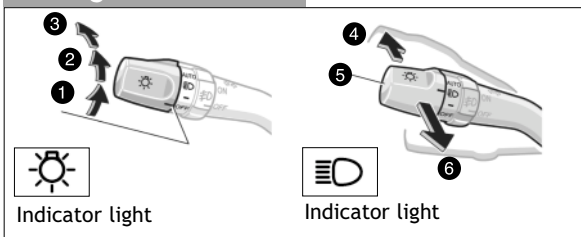

- 1 **Parking, tail, license plate, side marker and instrument panel lights** Twist the lever knob to position 1.
- 2 **Headlights and all of the above** Twist the lever knob to position 2.
- 3 **"AUTO"*** Twist the lever knob to position 3.
- 4 **High beams** Push the lever forward.
- 5 **Low beams**
- 6 **High beam flasher** Pull the lever toward you.

Note: Daytime running light system* Automatically turns on the headlights at reduced intensity.

*If installed

Automatic light cutoff system

Automatically turns off the lights when the driver's door is opened with the key in "ACC" or "LOCK."

Turn signals

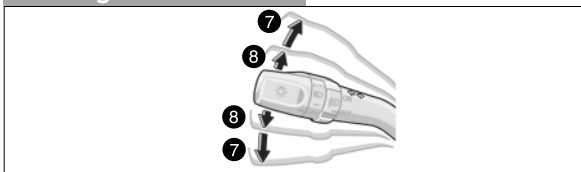

- 7 **Right or left turn** Push the lever up or down.
- 8 **Lane change** Move the lever up or down to position 8 and hold.

Clock



- To reset the hour Push "H."
- To reset the minute Push "M."
- To zero out minutes Push " :00."

Windows

Driver side

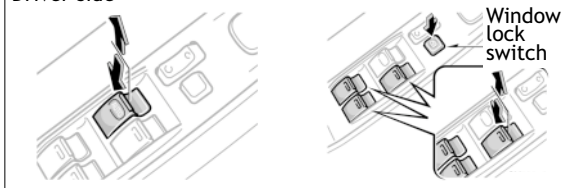

Window operation

To open or close Push down or pull up on the switch. **Automatic operation (Driver side only)** Push the switch completely down or pull it completely up and release to fully open or close. To stop mid-way, lightly push the switch in the opposite direction.

Window lock switch

Push the switch to deactivate the passenger windows.

Window-Back

Operating from inside

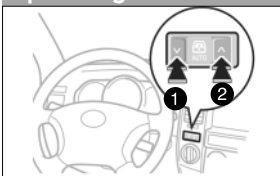

Operating from outside

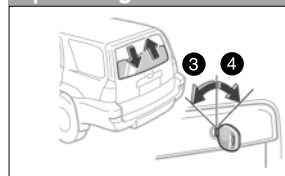

- 1 **To open** Push and hold "v."
- 2 **To close** Push and hold "^."
- 3 **To open** Turn the key counterclockwise and hold.
- 4 **To close** Turn the key clockwise and hold.

Tilt and telescopic (if installed) steering wheel

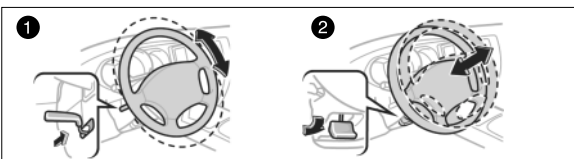

- 1 **To change the steering wheel angle** Hold the steering wheel, pull the lock release lever, tilt to the desired angle then release the lever.
- 2 **To change the steering wheel column length** Push the lock release lever down, set the desired length, and return the lever to its locked position.

Note: Do not attempt to adjust while the vehicle is in motion.

Cruise control

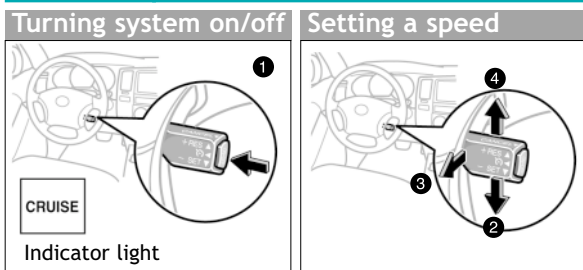

- 1 To turn the system "ON" or "OFF" Push the button.
- 2 To set a speed Bring your vehicle to the desired speed. Push the lever down toward "-SET."
- 3 To cancel the set speed Pull the lever to "CANCEL." The set speed may also be cancelled by depressing the brake pedal.
- 4 To resume set speed after cancel Push the lever up toward "+RES" after reaching a speed of 25 mph.

NOTE: To raise set speed, push up toward "+RES." To lower set speed, push down toward "-SET." Refer to the Owner's Manual for more details.

Garage door opener (HomeLink®)* (if installed)

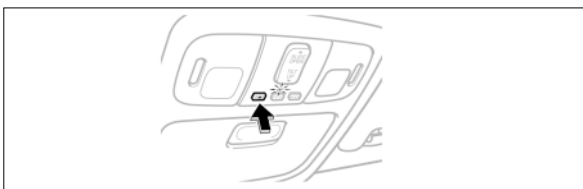

Garage door openers manufactured under license from HomeLink®* can be programmed to operate garage doors, estate gates, security lighting, etc.

Refer to the *Owner's Manual* for more details. For programming assistance, contact the Toyota Customer Experience Center at 1-800-331-4331, or visit <http://www.homelink.com>

*HomeLink® is a registered trademark of Johnson Controls, Inc.

Air conditioning/Heating

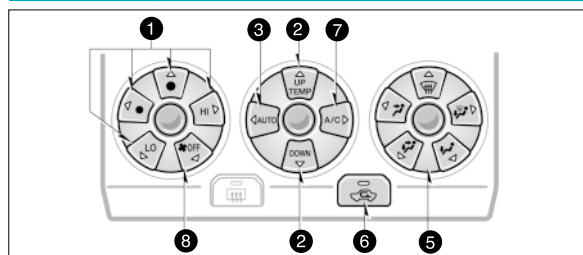

With "DUAL" button

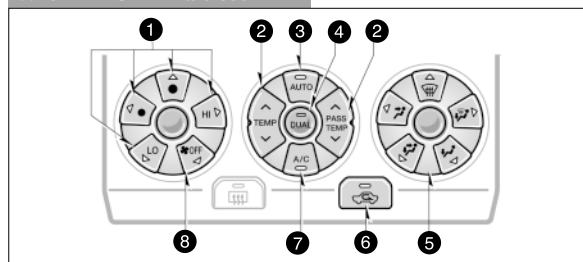

- 1 Fan speed selector
- 2 Temperature selector
- 3 "AUTO" button Push to turn automatic air conditioning on/off.
- 4 "DUAL" button Push to enable individual driver- and passenger-side settings. Enabled when indicator is "ON."
- 5 Air flow Select vents.
- 6 Air intake selector To clear windshield quickly, "🌬️" will only operate in fresh air mode. "🔄" will allow manual setting to recirculate. "🚗" Indicator light is on when recirculating.
- 7 "A/C" switch Air conditioning on/off switch. Use with "🚗" for best performance.
- 8 "OFF" switch Air conditioning off button.

Engine immobilizer

This is a theft deterrent system. The engine will start only when the electronic code in the key's transponder chip corresponds to the registered ID code for the vehicle. Please note that key replacement can be expensive.

Refer to the *Owner's Manual* for more details.

Audio

Type 1

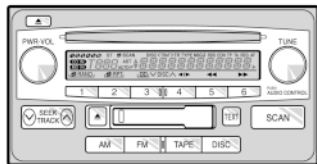

*Functions for buttons 1-6 are indicated above each button on LCD.

Type 2

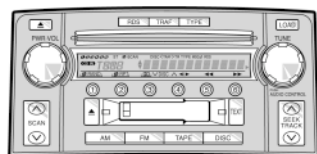

*Functions for buttons 1-6 are indicated above each button on LCD.

BASIC OPERATION

To turn on the audio system Push "PWR·VOL," "AM," "FM," "TAPE," "DISC" or "LOAD."

To turn off the system Push "PWR·VOL."

To adjust the volume Turn "PWR·VOL."

To adjust tone and balance Push the "TUNE·AUDIO CONT" knob. The mode changes with each push in succession from Bass, Midrange, Treble, Fade, Balance. Turn the knob right or left to adjust each mode.

RADIO

To select a station Push either side of "SEEK/TRACK."

To scan for stations Push "SCAN." Push and hold to scan preset stations. Push again to hold selection.

To select the band Push "AM," or "FM."

-To preset a station Tune in the desired station and press a preset button (1-6) until you hear a beep.

-To select a preset station Push desired preset button (1-6).

Type 2 only is equipped with ...

RDS (Radio Data System - FM only)

-Push "TYPE" to select station genre.

-Push steering wheel switches "∧" or "∨," or preset button (1-6) to select stations within genre.

-Push "TEXT" to receive information transmitted from radio stations.

CASSETTE TAPE PLAYER

To play Insert a cassette tape.

To fast forward Push "▶▶."

To rewind Push "◀◀."

To select a direction Push "◀▶."

To eject a cassette tape Push "▲."

CD PLAYER

To play Insert a compact disc.

To select a track Push "SEEK/TRACK."

To scan tracks on a disc Push "SCAN." Push again to hold a selection.

To eject a compact disc Push "▲."

To view CD text Push "TEXT" to display disc and track titles.

Type 2 only are equipped with ...

1 CD Changer

-To load one disc Push "LOAD" and insert 1 disc.

-To load multiple discs Push and hold "LOAD" until you hear a beep. Insert one disc. Shutter will close and then re-open for next disc.

Steering wheel switches (if installed)

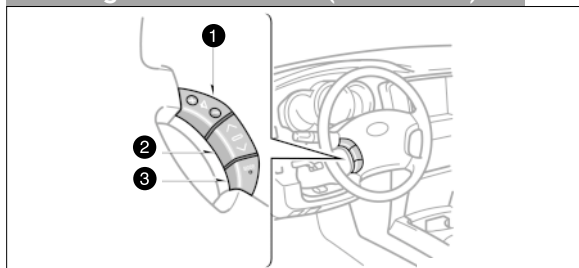

1 Volume control switch

2 "∧ ∨" switch

-In radio mode Push to select a preset station, push and hold to scan for a station.

-In tape mode Push to skip up or down to a next/previous track, push and hold to fast forward or reverse.

-In CD mode Push to skip up or down to a next/previous track.

3 "MODE" switch Push to select an audio mode. Push and hold to turn the audio system "OFF."

Refer to the *Owner's Manual* for more details.

Bottle holders

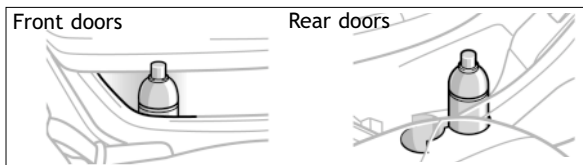

Cup holders

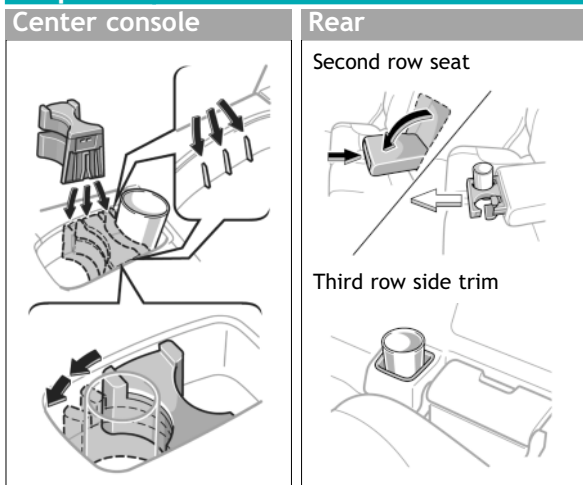

Auto LSD (Limited Slip Differential) (if installed)

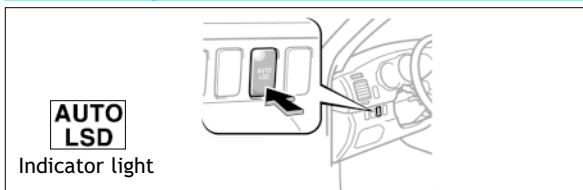

Push the "AUTO LSD" switch when the vehicle is stopped. To deactivate, push the switch again.

This system aids traction by using the Traction Control system to control engine performance and braking when one of the rear wheels begins to spin. It should **ONLY** be used when wheel spinning occurs in a ditch or on rough surfaces.

Refer to the *Owner's Manual* for complete details on this system before attempting to use it.

Keyless entry

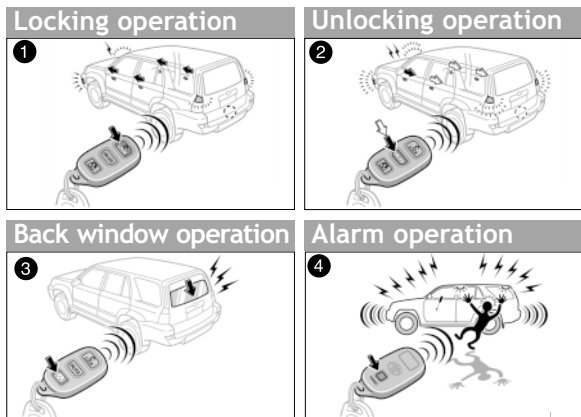

- 1 To lock Push "LOCK."
- 2 To unlock driver door Push "UNLOCK" once.
To unlock all the doors Push "UNLOCK" twice.

NOTE: After unlocking, if a door is not opened within thirty (30) seconds, all doors will relock for safety.

- 3 To open Push and hold the switch.
- 4 To activate alarm with remote Push "PANIC."

Refer to the *Owner's Manual* for more details.

Power outlets

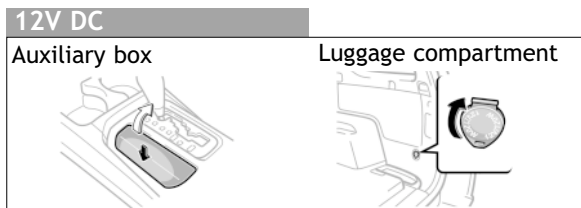

Designed for car accessories. Key must be in the "ACC" or "ON" position to be used.

115V AC (if installed)

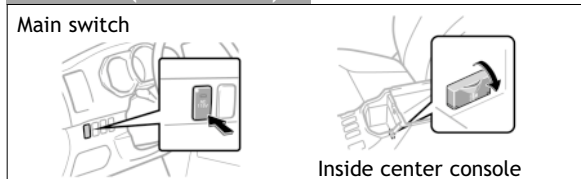

To use Push the Main switch while engine is running. Refer to the *Owner's Manual* for more details.

SAFETY AND EMERGENCY FEATURES

Door locks-Power

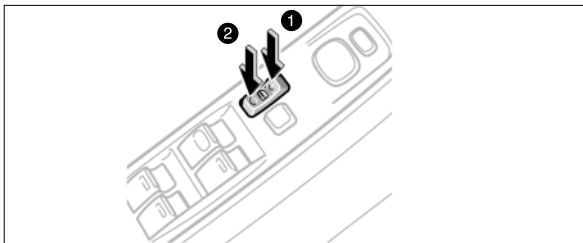

- ① To lock Push down on the front of the switch.
- ② To unlock Push down on the back of the switch.

Doors-Child safety locks

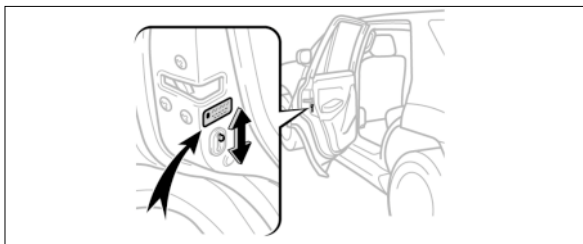

To lock the inside handle Move the lever to "LOCK," allowing the door to be opened only from the outside.

Seat belts

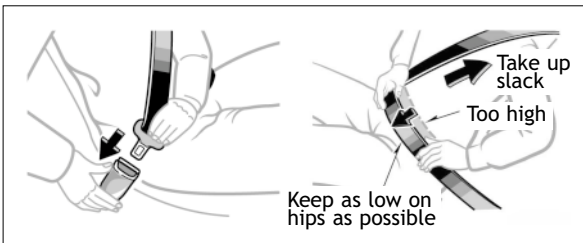

If belt is fully extended, then retracted even slightly, it cannot be re-extended beyond that point, unless fully retracted again. This feature is used to help hold child restraint systems securely.

To find more information about seat belts, and how to install a child restraint system, refer to the *Owner's Manual*.

Seat belts-Shoulder belt anchor

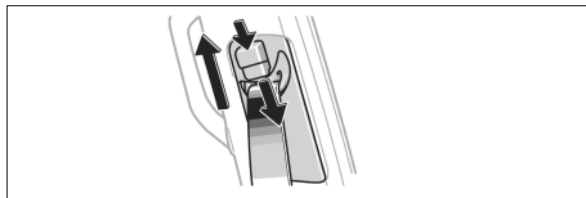

To raise Slide the anchor upward.

To lower Squeeze the lock release button and slide the anchor downward.

DAC (Downhill Assist Control)(if installed)*

Four-wheel drive models only

To turn on/off Push the DAC button. The system will assist the engine brake when driving down a steep hill.

TRAC (Traction Control)(if installed)*

Two-wheel drive models only

Helps control spinning of the rear wheels, which may occur when accelerating on slippery roads.

ATrac (Active Traction Control)(if installed)*

Four-wheel drive models only

Helps control spinning of the wheels, which may occur when accelerating on slippery roads.

VSC¹ (Vehicle Stability Control)*

Helps provide comprehensive control of the Anti-lock Brakes, Brake-Assist², Traction Control, engine control and other systems. This system helps maintain control of the vehicle under adverse conditions.

*Refer to the *Owner's Manual* for more details.

¹ *Vehicle Stability Control (VSC) is an electronic system designed to help the driver maintain vehicle control under adverse conditions. It is not a substitute for safe driving practices. Factors including speed, road conditions and driver steering input can all affect whether VSC will be effective in preventing loss of control.*

² *Brake-Assist is designed to help the driver take full advantage of the benefits of ABS (Anti-lock Brake System). It is not a substitute for safe driving practices. Braking effectiveness also depends on proper brake-system maintenance and tire and road conditions.*

Parking brake

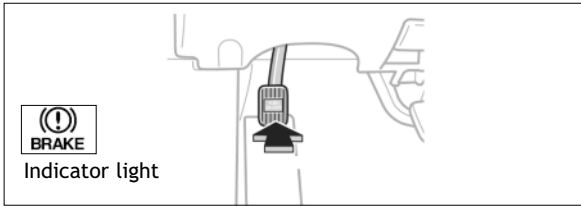

To set Depress the pedal.

To release Depress the pedal again.

Tire Pressure Warning System

The system is designed to provide warning when tire pressure of any one of the tires (including the spare) is reduced.

Refer to the *Owner's Manual* for more details.

Airbag-Supplemental Restraint System

The Airbag Supplemental Restraint System (SRS) front, side* and side curtain* airbags are designed to help provide further protection for the driver and outboard passenger in addition to the primary safety protection provided by the seat belts.

Front passenger occupant classification system

Monitors the load on the front passenger seat, and detects if the seat belt is fastened to determine passenger occupancy and size of passenger, if any.

For the system to correctly determine conditions

- Do not place heavy objects on the front passenger seat.
- Do not attach a seatback table to the front passenger seatback.
- Do not put weight on the front passenger seat by putting your hands or feet on the front passenger seatback from the rear passenger seat.

Please read the following caution, and refer to the *Owner's Manual* for more details.

*If installed

CAUTION



- The driver and front passenger airbag Supplemental Restraint System (SRS) is designed only as a supplement to the primary protection of the seat belt systems of the driver and front passenger. The front seat occupants are particularly susceptible to injury if they do not wear their seat belts; when sudden braking or a collision occurs, they may be thrown forward. To obtain maximum protection in an accident, the driver and all passengers in the vehicle should always wear their seat belts when driving because serious injuries or death can result to unrestrained occupants. For instructions and precautions concerning the seat belt system, see "Seat belts" in the *Owner's Manual*.
- Toyota strongly urges the use of a proper child restraint system on the rear seat that conforms to the size of the child. According to accident statistics, a child is safer when properly restrained in the rear seat than on the front seat.
- Never** use a rear-facing child restraint system in the front seat even if the front passenger occupant classification indicator light is "OFF." The force of the rapid inflation of the passenger airbag can cause severe injury or death to a child.
- Unless it is unavoidable, do not install a forward-facing child restraint system in the front seat even if the front passenger occupant classification indicator light is "OFF." If you must install a forward-facing child restraint system in that the front seat, move the seat as far back as possible.
- Make sure you have complied with all installation instructions provided by the child restraint manufacturer and the system is properly secured.
- Make sure the front passenger occupant classification indicator light indicates "ON" when using the seat belt extender for the front passenger seat. If the indicator light indicates "OFF," disconnect the extender tongue from the seat belt buckle, then reconnect the seat belt. Reconnect the seat belt extender after making sure the indicator light indicates "ON." If you use the seat belt extender while the indicator light indicates "OFF," the front passenger airbag and side airbag on the front passenger side may not activate correctly, which could cause death or serious injury in the event of collision.
- If an adult sits in the front passenger seat, the occupant classification indicator light should indicate "ON." If the "OFF" indicator is illuminated, ask the passenger to sit up straight, well back in the seat, feet on the floor, and with the seat belt worn correctly. If the "OFF" indicator still remains illuminated, either ask the passenger to move to the rear seat, or if that is not possible, move the front passenger seat fully rearward.
- The SRS side and side curtain airbags (optional) are designed to deploy in certain types of severe side impact collisions. In all other collisions, the side impact and side curtain airbags will not deploy. For instructions and precautions, see your *Owner's Manual*.
- Do not lean against the side doors when the vehicle is in use. The side and side curtain airbags inflate with considerable speed and force. Death or serious injury could result.
- Do not modify, cover or replace the surface of the front seats. Such changes could disable the system or prevent the airbags from activating correctly, resulting in death or serious injury.

Rollover Information

This vehicle will handle and maneuver differently from an ordinary passenger car because it is also designed for off-road use. It has a higher ground clearance and higher center of gravity than an ordinary passenger car. This vehicle design feature causes this type of vehicle to be more likely to roll over. Utility vehicles have a significantly higher rollover rate than other types of vehicles.

An advantage of the higher ground clearance is a better view of the road allowing you to anticipate problems. However, it is not designed for cornering at the same speeds as ordinary passenger cars any more than low-slung sports cars are designed for off-road use. Therefore, sharp turns at excessive speeds may cause rollover.

Failure to operate this vehicle correctly may result in loss of control, accidents or vehicle rollover causing death or serious injury. Be sure to read your Owner's Manual for more information on safe driving both on and off-road.

 WARNING: HIGHER ROLLOVER RISK		
	<p>Avoid Abrupt Maneuvers and Excessive Speed.</p> <p>Always Buckle Up.</p> <p>See Owner's Manual For Further Information.</p>	

Always observe the following precautions to minimize the risk of serious personal injury or damage to your vehicle:

- In a rollover crash, an unbelted person is significantly more likely to die than a person wearing a seat belt. Therefore, the driver and all passengers should fasten their seat belts whenever the vehicle is moving.
- Avoid sharp turns or abrupt maneuvers, if at all possible. Failure to operate this vehicle correctly may result in loss of control or vehicle rollover causing death or serious injury.
- Loading cargo on the roof luggage carrier will make the center of the vehicle gravity higher. Avoid high speeds, sudden starts, sharp turns, sudden braking or abrupt maneuvers; otherwise, it may result in a loss of ability to operate this vehicle correctly.
- Always slow down in gusty crosswinds. Because of its profile and higher center of gravity, your vehicle is more sensitive to side winds than an ordinary passenger car. Slowing down will allow you to have better control.
- When driving off-road or in rugged terrain, do not drive at excessive speeds, jump, make sharp turns, strike objects, etc. This may cause loss of control or vehicle rollover causing death or serious injury. You are also risking expensive damage to your vehicle's suspension and chassis.
- Do not drive horizontally across steep slopes. Driving straight up or straight down is preferred. Your vehicle (or any similar off-road vehicle) can tip over sideways much more easily than forward or backward.

Spare tire & tools

Tool location

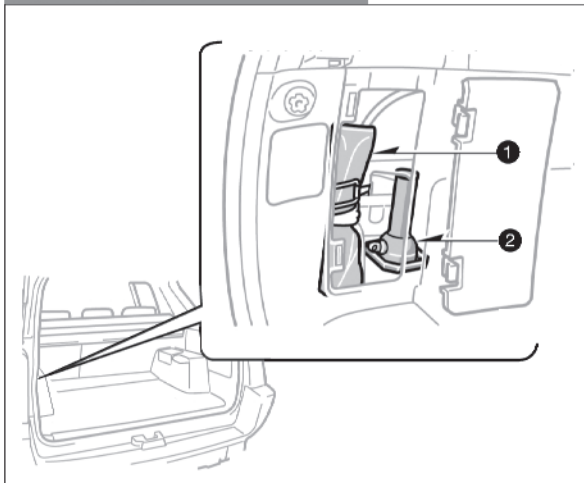

- 1 Tool bag
- 2 Jack

Removing the spare tire

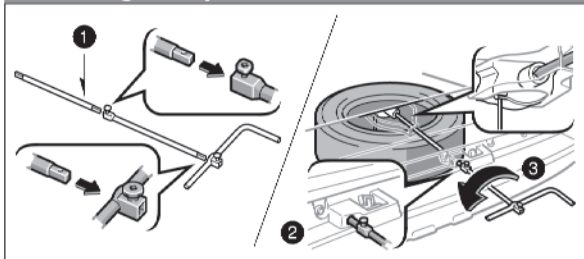

- 1 Assemble the jack handle.
- 2 Insert the jack handle end through the opening in the bumper, and into the lowering screw.
- 3 Turn the jack handle counterclockwise.

Refer to the *Owner's Manual* for jack positioning and tire changing procedures.

If you have any questions or comments
please contact the Toyota Customer
Experience Center at 1-800-331-4331, or
visit our informative, interactive Web site at
<http://www.toyota.com>

