

SUSPENSION AND AXLE

■ SUSPENSION

1. General

As in the '02 4Runner, the double-wishbone independent suspension for front and the 4-link coil spring with lateral rod type suspension for rear are used on the '03 4Runner. However, these front and rear suspensions have been newly developed to ensure the proper off-road drivability, controllability, and riding comfort of the '03 4Runner.

- A newly developed reciprocal shock absorber system called the “X-REAS” (Relative Absorber System), which enhances drivability by effecting comprehensive 4-wheel control, is provided as optional equipment on all models.
- Furthermore, a newly developed air suspension that uses pneumatic cylinders instead of coil springs, is provided as a set option with the X-REAS in the rear suspension of the Limited grade.
- The '03 4Runner has a suspension with the following equipment:

Engine		2UZ-FE			
Drive Type		2WD		4WD	
Grade		SR5	Limited	SR5	Limited
Shock Absorber System	Conventional	STD	←	←	←
	X-REAS	OPT	←	←	←
Rear Suspension	Coil Spring	STD	←	←	←
	Air Suspension	—	OPT*	—	OPT*

*: Set option with X-REAS.

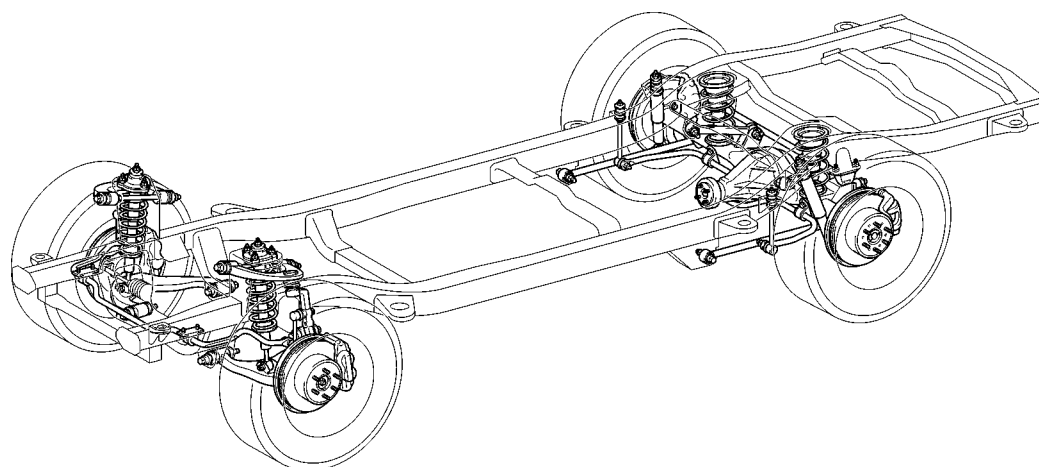

Standard Suspension

232CH04

X-REAS is YAMAHA's registered trademark.

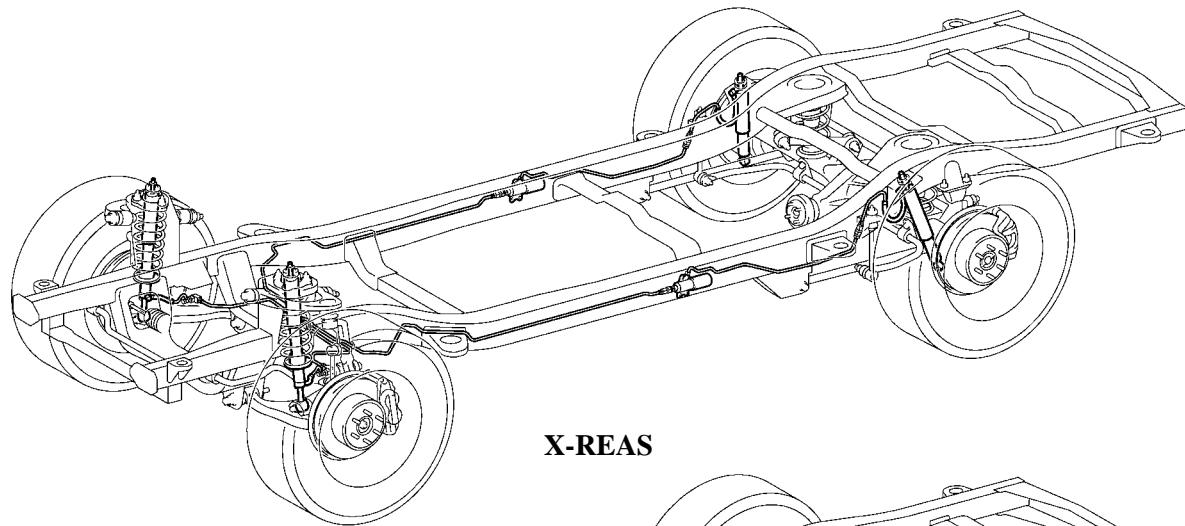

X-REAS

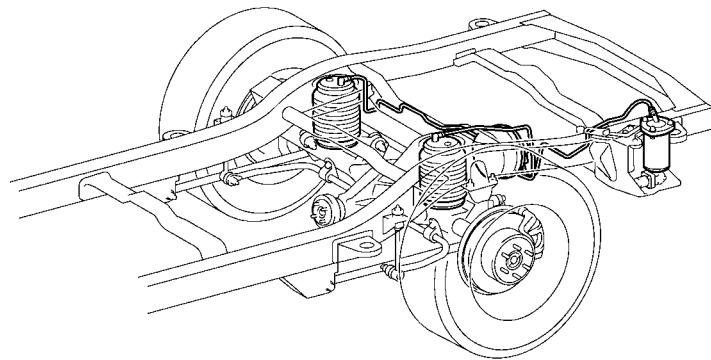

Rear Air Suspension

232CH05

► **Specification** ◀

		Drive Type	2WD	4WD	
Tread	Front	mm (in.)	1575 (62.0)	←	
	Rear	mm (in.)	1575 (62.0)	←	
Front Wheel Alignment*	Caster	degree	Rear Coil Spring	3°23'	3°13'
			Rear Air Suspension	3°33'	3°22'
	Camber	degree	Rear Coil Spring	-0°28'	-0°09'
			Rear Air Suspension	-0°30'	-0°10'
	Toe-In	mm (in.)	1 (0.04)	←	
	King Pin Inclination	degree	Rear Coil Spring	12°58'	12°39'
		Rear Air Suspension	13°00'	12°40'	

*: Unloaded Condition

2. Standard Front and Rear Suspension

Through the optimal allocation of components, and the front and rear suspensions realizes excellent riding comfort, controllability, and off-road drivability.

► Front Suspension ◀

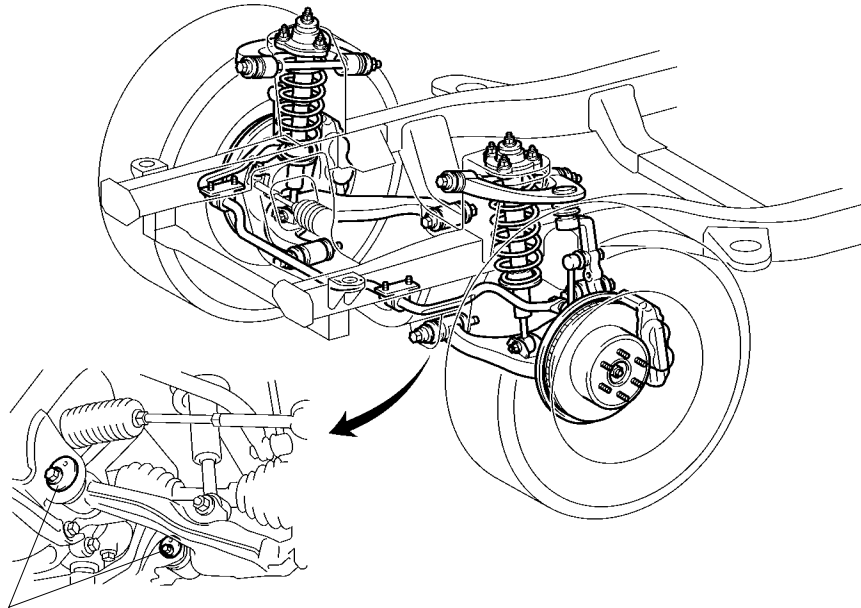

Adjustment
Cams

232CH06

Service Tip

The camber and caster of the front suspension are adjusted at the adjustment cams of the lower arms, and the toe-in is adjusted by changing the lengths of the tie-rod ends. The basic adjustment procedure is the same as the '02 4Runner. For details, see the 2003 4Runner Repair Manual (Pub. No. RM1001U).

► Rear Suspension ◀

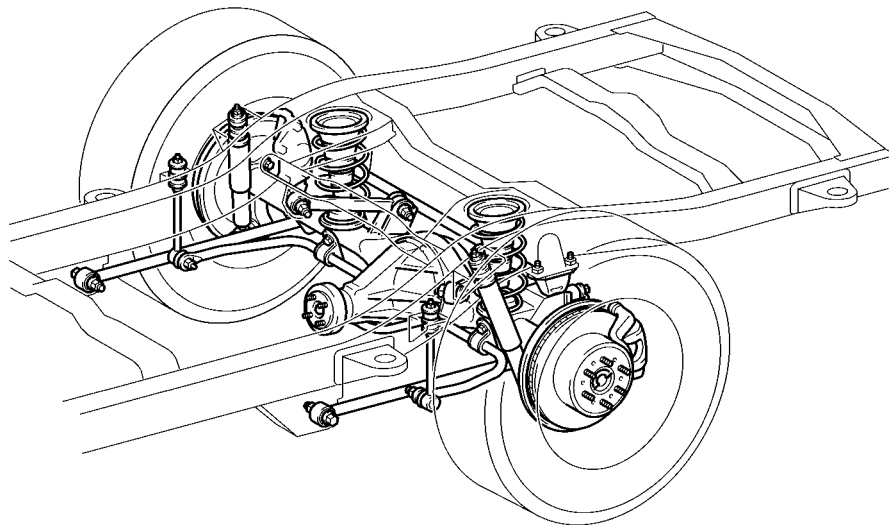

232CH07